

Soils Map

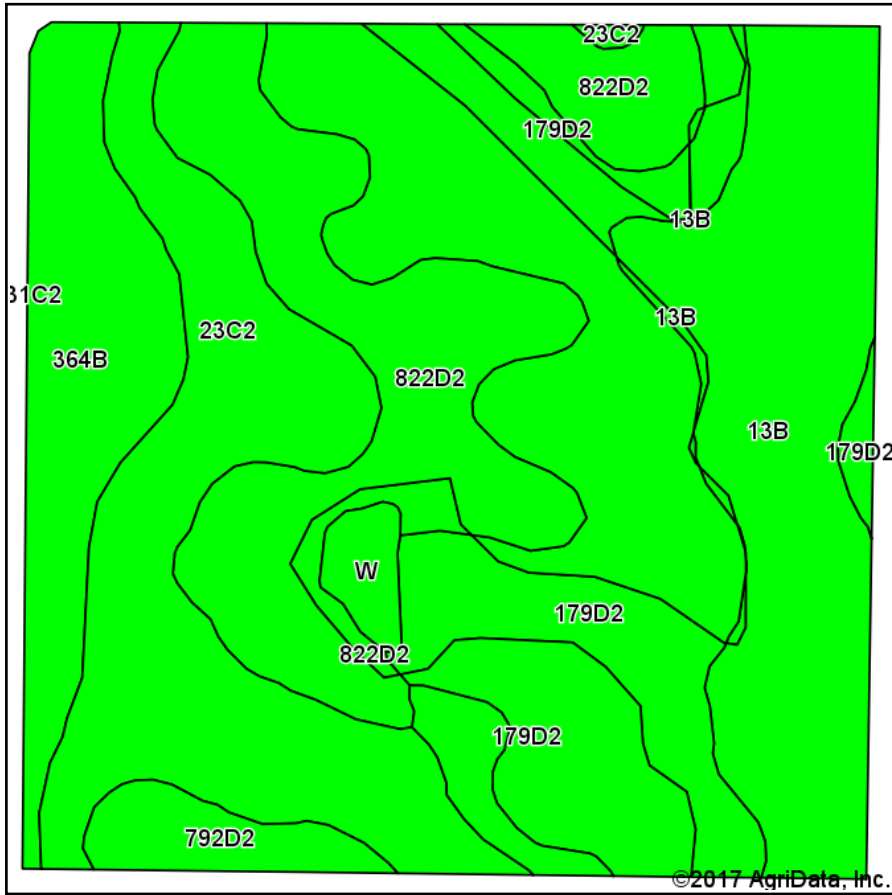

Soils data provided by USDA and NRCS.

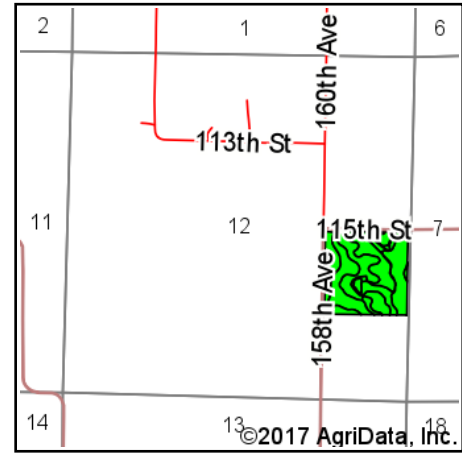

State: **Iowa**
 County: **Decatur**
 Location: **12-70N-27W**
 Township: **Richland**
 Acres: **37.01**
 Date: **3/20/2017**



Maps Provided By:



© AgriData, Inc. 2017

www.AgriDataInc.com



Area Symbol: IA053, Soil Area Version: 22

Code	Soil Description	Acres	Percent of field	CSR2 Legend	Non-Irr Class *c	*i Corn	*i Alfalfa	*i Soybeans	*i Bluegrass	*i Tall Grasses	CSR2**	CSR	NCCPI Overall
179D2	Gara clay loam, 9 to 14 percent slopes, moderately eroded	10.89	29.4%		IVe	163.2	4.6	47.3	2.9	4.9	43	43	65
822D2	Lamoni clay loam, 9 to 14 percent slopes, moderately eroded	6.96	18.8%		IVe	100.8	2.6	29.2	1.8	3	30	15	58
13B	Olmitz-Zook-Vesser complex, 0 to 5 percent slopes	6.77	18.3%		IIw	200	4.2	58	3.6	6	76	55	84
23C2	Arispe silty clay loam, 5 to 9 percent slopes, moderately eroded	6.71	18.1%		IIIe	169.6	4.4	49.2	3.1	5.1	62	50	82
364B	Grundy silty clay loam, 2 to 5 percent slopes	3.68	9.9%		IIe	198.4	5.2	57.5	3.6	6	72	75	78
792D2	Armstrong clay loam, 9 to 14 percent slopes, moderately eroded	1.54	4.2%		IVe	88	2.3	25.5	1.6	2.6	5	13	51
W	Water	0.46	1.2%			0	0	0	0	0	0	0	0
Weighted Average						157.7	4	45.7	2.8	4.7	50.8	42.6	70.1

**IA has updated the CSR values for each county to CSR2.

*i Yield data provided by the ISPAID Database version 8.1 developed by IA State University.

*c: Using Capabilities Class Dominant Condition Aggregation Method

Soils data provided by USDA and NRCS.