

Soils Map

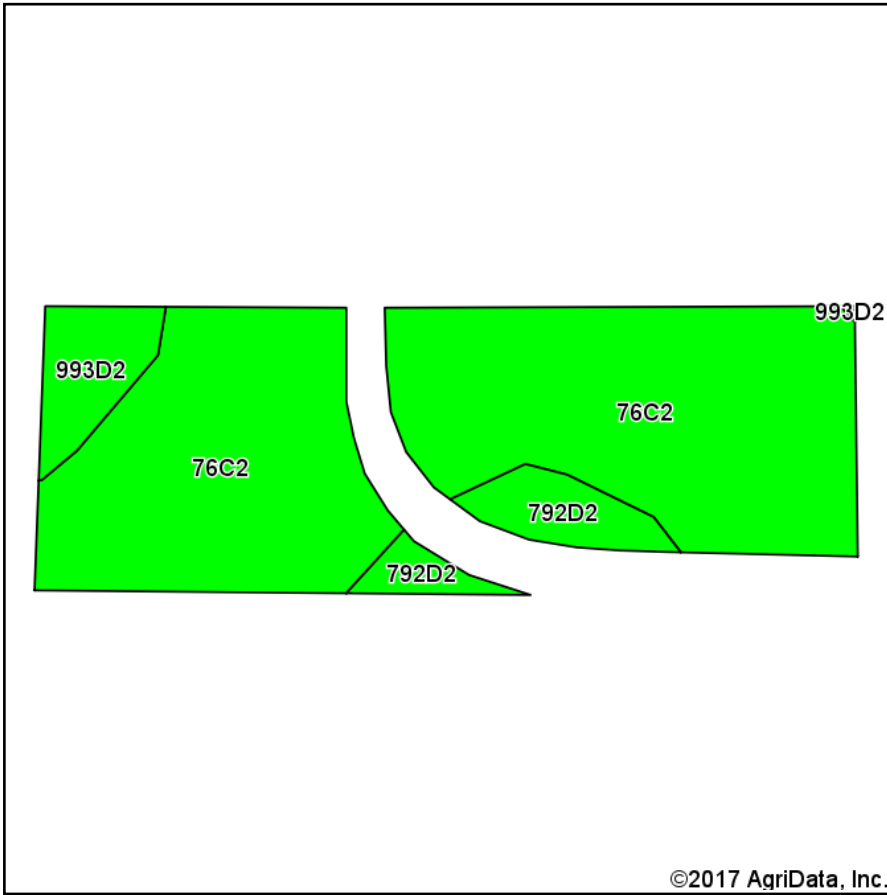

Soils data provided by USDA and NRCS.

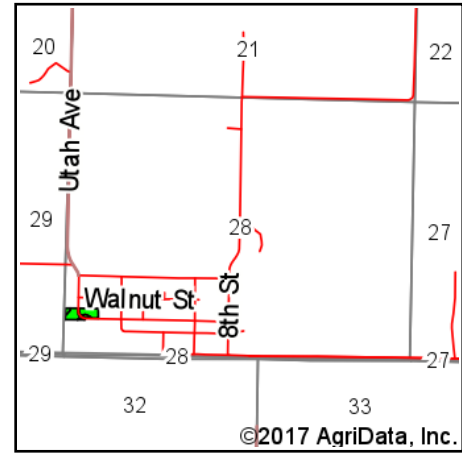

State: **Iowa**
 County: **Taylor**
 Location: **28-67N-32W**
 Township: **Jefferson**
 Acres: **1.79**
 Date: **6/19/2017**



Maps Provided By:



© AgriData, Inc. 2017

www.AgriDataInc.com



Area Symbol: IA173, Soil Area Version: 27

Code	Soil Description	Acres	Percent of field	CSR2 Legend	Non-Irr Class *c	*i Corn	*i Alfalfa	*i Soybeans	*i Bluegrass	*i Tall Grasses	CSR2**	CSR	NCCPI Overall
76C2	Ladoga silty clay loam, 5 to 9 percent slopes, moderately eroded	1.53	85.5%		IIIe	192	5.4	55.7	3.5	5.8	75	62	72
792D2	Armstrong clay loam, 9 to 14 percent slopes, moderately eroded	0.14	7.8%		IVe	88	2.3	25.5	1.6	2.6	5	13	52
993D2	Gara-Armstrong complex, 9 to 14 percent slopes, moderately eroded	0.12	6.7%		IVe	123.2	3.2	35.7	2.2	3.7	28	31	61
Weighted Average						179.3	5	52	3.3	5.4	66.4	56.1	69.7

**IA has updated the CSR values for each county to CSR2.

*i Yield data provided by the ISPAID Database version 8.1 developed by IA State University.

*c: Using Capabilities Class Dominant Condition Aggregation Method

Soils data provided by USDA and NRCS.