

Soils Map

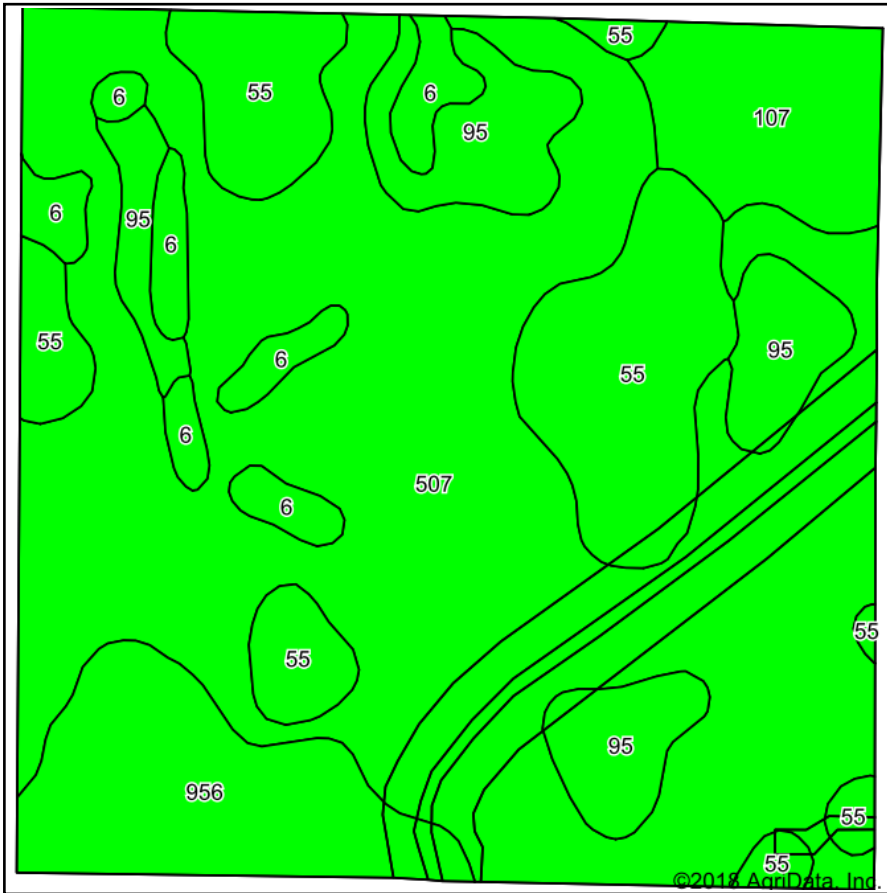

Soils data provided by USDA and NRCS.

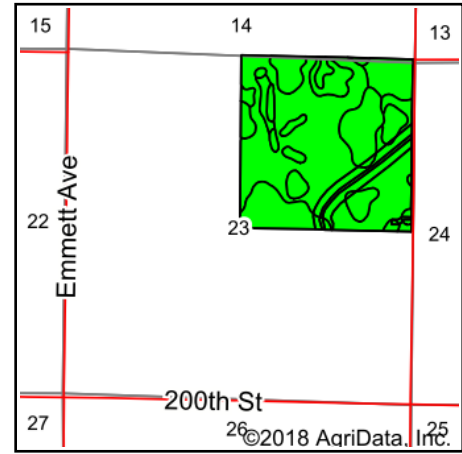

State: **Iowa**
 County: **Wright**
 Location: **23-92N-26W**
 Township: **Liberty**
 Acres: **160.28**
 Date: **11/30/2018**



Maps Provided By:



Area Symbol: IA197, Soil Area Version: 25

Code	Soil Description	Acres	Percent of field	CSR2 Legend	Non-Irr Class *c	*i Corn	*i Soybeans	CSR2**	CSR	*n NCCPI Overall
507	Canisteo clay loam, 0 to 2 percent slopes	91.43	57.0%		Ilw	224	65	84	78	79
55	Nicollet clay loam, 1 to 3 percent slopes	23.72	14.8%		lw	233.6	67.7	89	88	82
95	Harps clay loam, 0 to 2 percent slopes	14.55	9.1%		Ilw	198.4	57.5	72	62	77
956	Harps-Okoboji complex, 0 to 2 percent slopes	13.92	8.7%		Ilw	164.8	47.8	69	59	78
107	Webster clay loam, 0 to 2 percent slopes	9.16	5.7%		Ilw	224	65	86	83	80
6	Okoboji silty clay loam, 0 to 1 percent slopes	7.50	4.7%		Illw	177.6	51.5	59	57	80
Weighted Average						215.8	62.6	81.3	75.7	*n 79.3

**IA has updated the CSR values for each county to CSR2.

*i Yield data provided by the ISPAID Database version 8.1.1 developed by IA State University.

*n: The aggregation method is "Weighted Average using major components"

*c: Using Capabilities Class Dominant Condition Aggregation Method

Soils data provided by USDA and NRCS.