

Soils Map

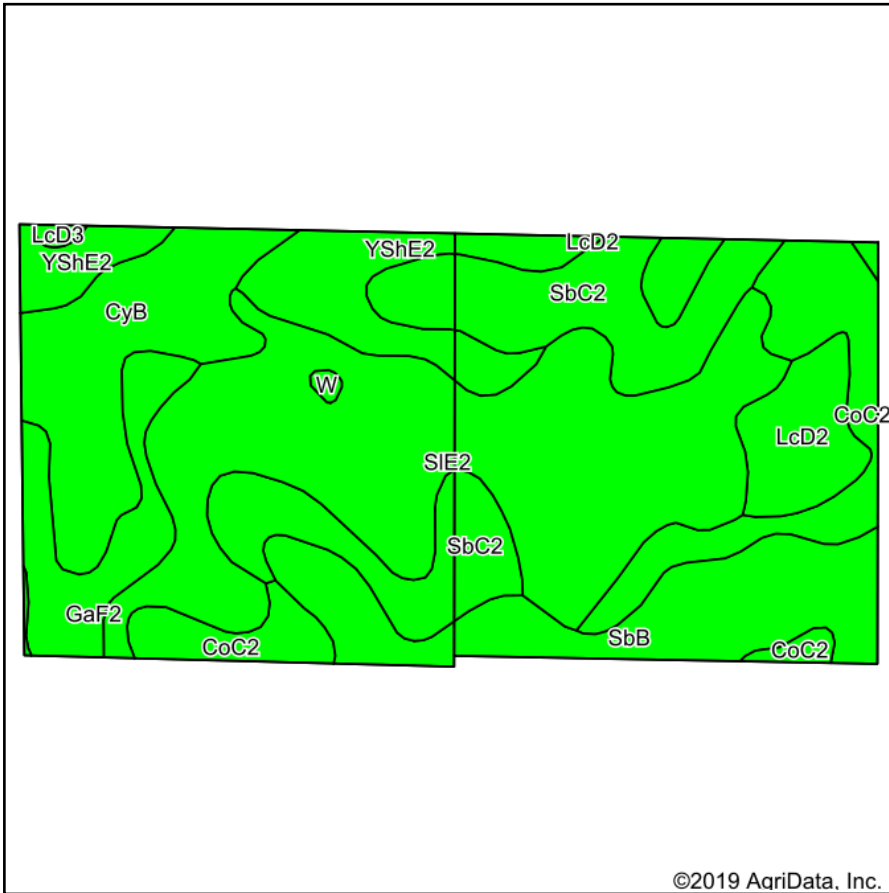

Soils data provided by USDA and NRCS.

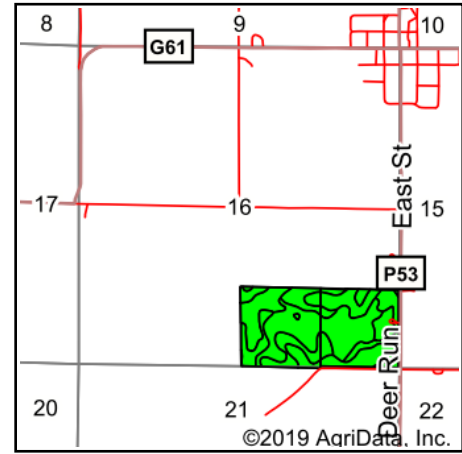

State: **Iowa**
 County: **Madison**
 Location: **16-74N-29W**
 Township: **Grand River**
 Acres: **77.46**
 Date: **5/7/2019**



Area Symbol: IA121, Soil Area Version: 22

Code	Soil Description	Acres	Percent of field	CSR2 Legend	Non-Irr Class *c	*i Corn	*i Soybeans	CSR2**	CSR	*n NCCPI Overall
SIE2	Shelby-Lamoni complex, 14 to 18 percent slopes, moderately eroded	24.50	31.6%		Vle	88	25.5	27	10	59
SbC2	Sharpsburg silty clay loam, 5 to 9 percent slopes, eroded	11.75	15.2%		Ille	204.8	59.4	80	67	71
SbB	Sharpsburg silty clay loam, 2 to 5 percent slopes	10.20	13.2%		Ile	225.6	65.4	91	87	93
CyB	Colo-Ely silty clay loams, gullied, 2 to 5 percent slopes	8.41	10.9%		Vw	80	23.2	57	10	43
CoC2	Clearfield silty clay loam, dissected till plain, 5 to 9 percent slopes, eroded	7.89	10.2%		Illw	163.2	47.3	56	45	61
YShE2	Shelby clay loam, dissected till plain, 14 to 18 percent slopes, eroded	6.64	8.6%		IVe	0	0	35		64
GaF2	Gara loam, dissected till plain, 18 to 25 percent slopes, eroded	4.36	5.6%		Vlle	115.2	33.4	16	13	50
LcD2	Lamoni clay loam, 9 to 14 percent slopes, moderately eroded	3.36	4.3%		IVe	100.8	29.2	10	15	52
LcD3	Lamoni clay loam, 9 to 14 percent slopes, severely eroded	0.19	0.2%		Vle	89.6	26	5	5	38
W	Water	0.16	0.2%			0	0	0	0	
Weighted Average						125	36.2	48.9	*	*n 63.2

**IA has updated the CSR values for each county to CSR2.

*- CSR weighted average cannot be calculated on the current soils data, use prior data version for csr values.

*i Yield data provided by the ISPAID Database version 8.1.1 developed by IA State University.

*n: The aggregation method is "Weighted Average using major components"

*c: Using Capabilities Class Dominant Condition Aggregation Method

Soils data provided by USDA and NRCS.